

INDUSTRIAL/WAREHOUSE
FOR LEASE AVAILABLE NOW

Five Oaks West Business Park

5950 NE Jacobsen Street, Suite 140, Hillsboro, OR 97124
Building 11



Jake Bigby
jakeb@pactrust.com

Caitlin Knecht
caitlink@pactrust.com

503.624.6300
www.PacTrust.com

© 2025 PacTrust. All information supplied herein, including but not limited to measurements, dimensions, and specifications, is deemed reliable but is not guaranteed and should be independently verified. Any reliance on the information contained herein is at the user's own risk.

Key Features



21,642 sq. ft. shell
(includes restrooms)
divisible to ±10,821 sq. ft.



Build-to-suit office



4 dock doors
2 oversized grade doors

Move-in ready space

24' clear height

LED lighting

ESFR sprinklers

Ability for 53' trailers

Less than a mile to Hwy 26
interchange

Hillsboro offers a **business-friendly
tax structure** and variety of
incentives

[Learn more here](#)

Lease Rate (NNN):

\$0.95/sq. ft. shell

\$1.40/sq. ft. office

Owned & Managed by

PACTRUST

Space Plan

5950 NE Jacobsen Street, Suite 140, Hillsboro, OR 97124

21,642 Sq. Ft.

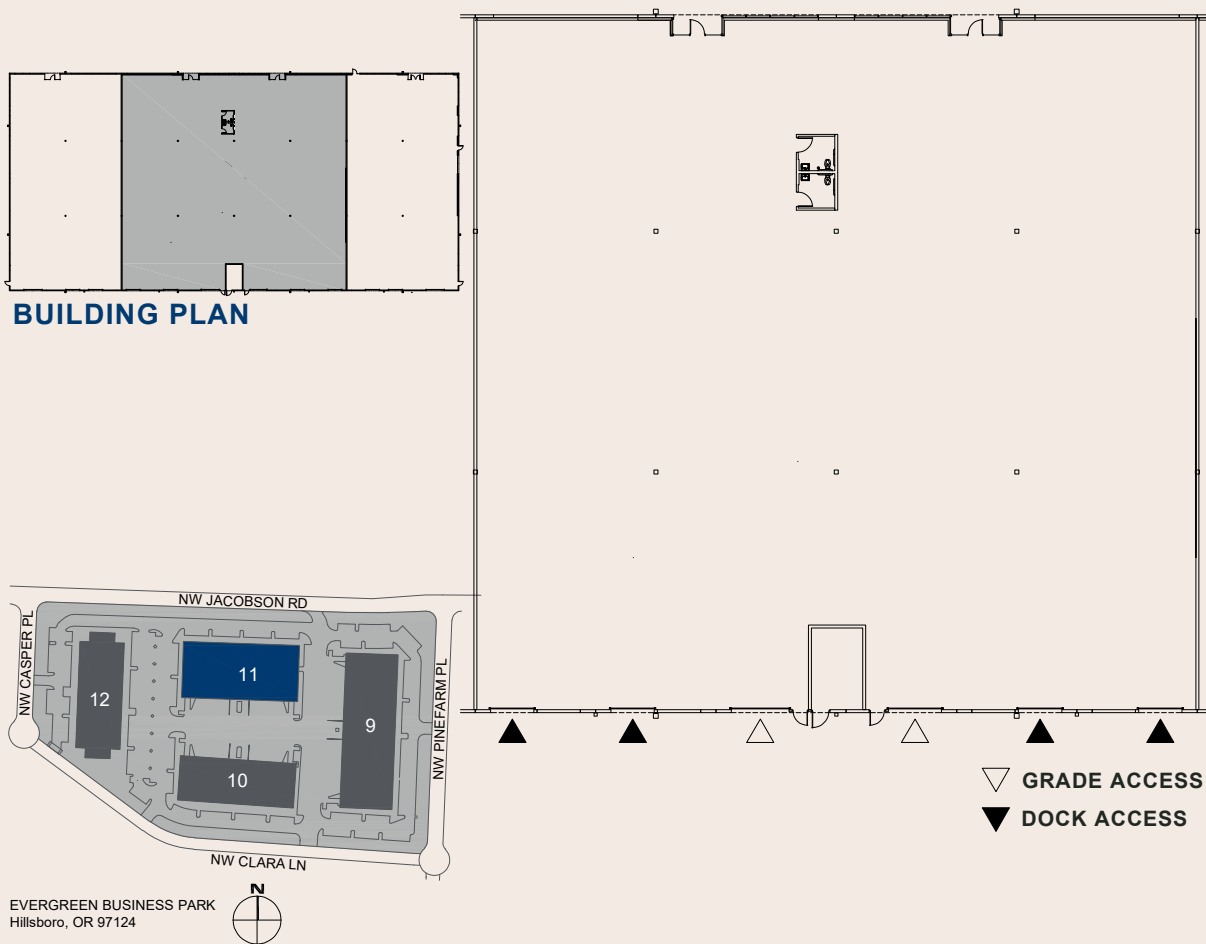

Jake Bigby
jakeb@pactrust.com

Caitlin Knecht
caitlink@pactrust.com

503.624.6300
www.PacTrust.com

INDUSTRIAL/WAREHOUSE
FOR LEASE AVAILABLE NOW

Owned & Managed by
PacTrust

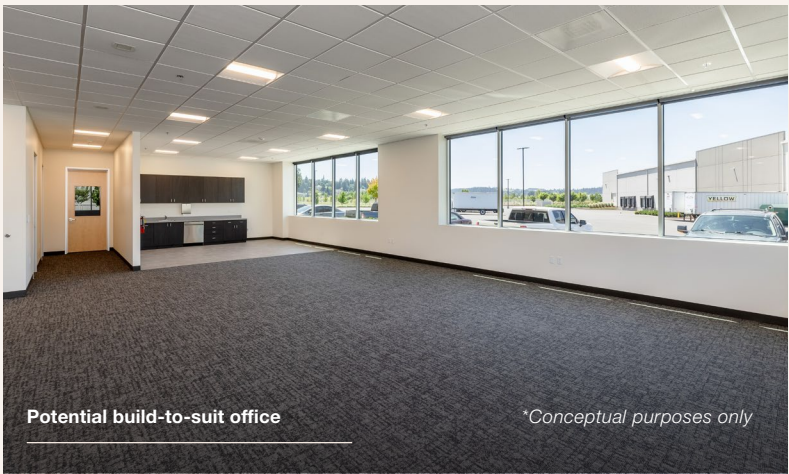

INDUSTRIAL/WAREHOUSE
FOR LEASE AVAILABLE NOW



Contact for more details

Jake Bigby
jakeb@pactrust.com

Caitlin Knecht
caitlink@pactrust.com

503.624.6300
www.pactrust.com

PacTrust